

# K2500 /2550 series Installation Dimensions & Tech Data

## Length calculation

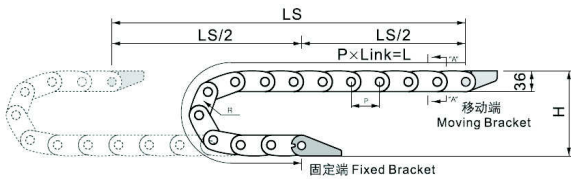

$$L = \frac{LS}{2} + \pi \times R + 180$$

L: Length  
R: bending Radius  
H: Installation Height  
P: Pitch  
180: Safety Length

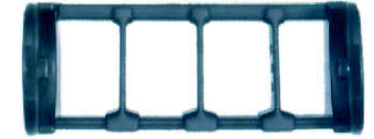
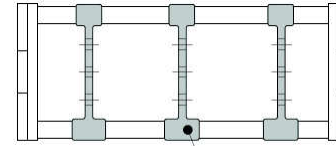
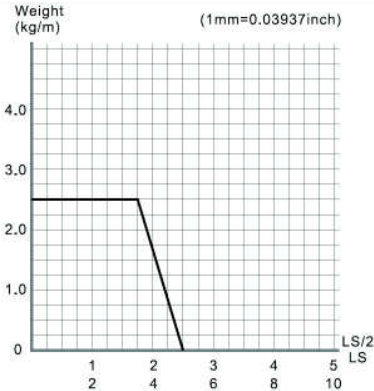

## Fixed bracket

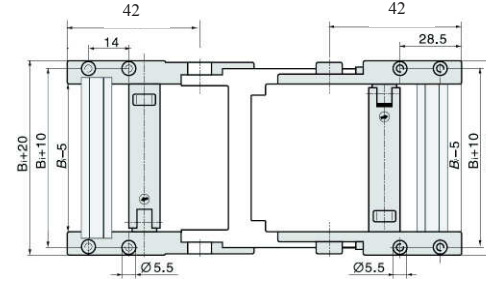

## Moving bracket

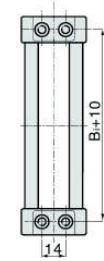

K2500 series can be open by both side

Type	Inner width (mm)	Outer width (mm)	Bending radius(mm)	Pitch (mm)	Weight (kg)
2500.038.□.0	38	55	55 75 100 125	47	1.05
2500.057.□.0	57	74	55 75 100 125	47	1.15
2500.077.□.0	77	94	55 75 100 125	47	1.30
2500.103.□.0	103	120	55 75 100 125	47	1.40

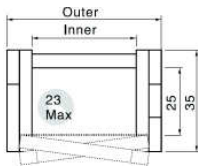

K2550 series can be open by both side

Type	Inner width (mm)	Outer width (mm)	Bending radius(mm)	Pitch (mm)	Weight (kg)
2550.038.□.0	38	55	55 75 100 125	47	1.15
2550.057.□.0	57	74	55 75 100 125	47	1.25
2550.077.□.0	77	94	55 75 100 125	47	1.40

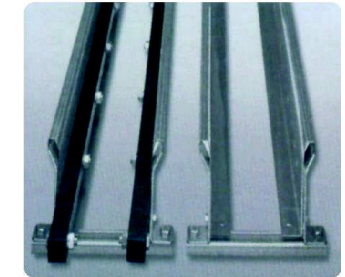
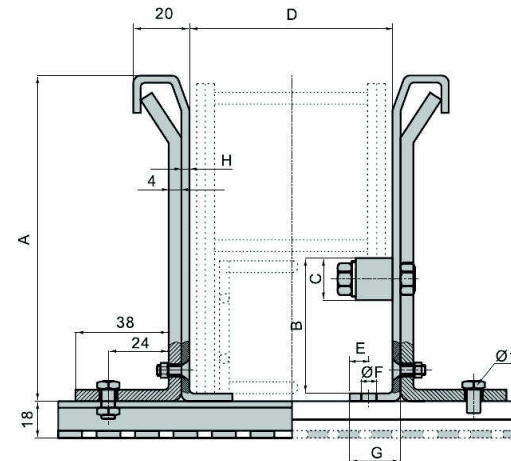
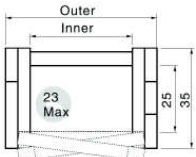

Cable tray without slide strip	1
Cable tray with slide strip	2
A	70
B	34
C	20
D	*
E	12
F	9
G	26
H	2