

K6500/6550 series Installation Dimensions & Tech Data

Length calculation

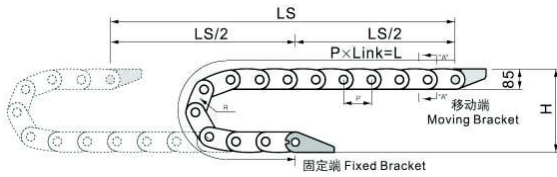

$$L = \frac{LS}{2} + \pi \times R + 364$$

L: Length
R: bending Radius
H: Installation Height
P: Pitch
364: Safety Length

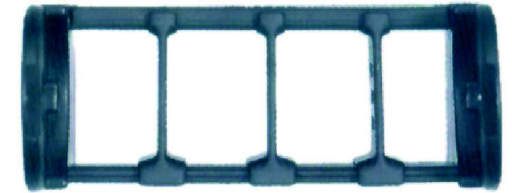
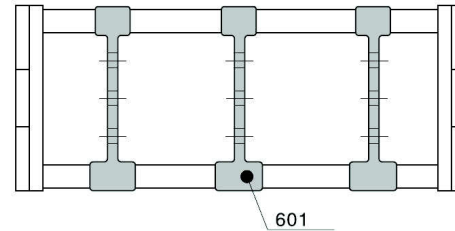
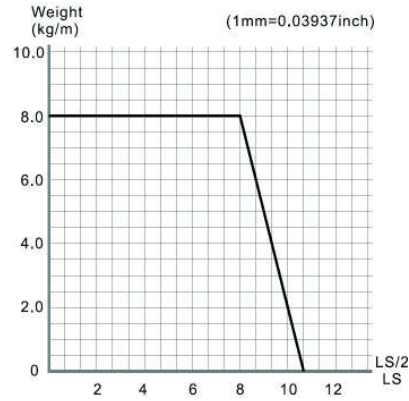

Fixed bracket

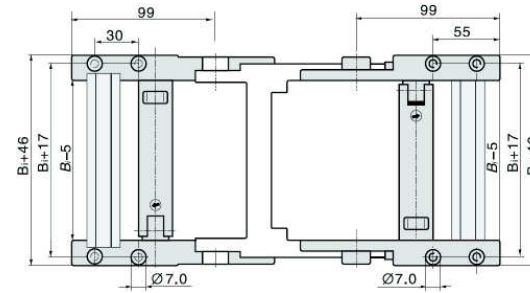

Moving bracket

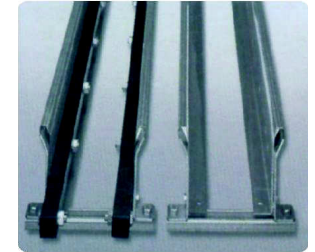
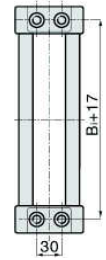

K6500 series can be open by both side

Type	Inner width (mm)	Outer width (mm)	Bending radius(mm)	Pitch (mm)	Weight (kg)
6500.100.□.0	100	152	150 200 250 300 350	91	4.30
6500.125.□.0	125	177	150 200 250 300 350	91	4.40
6500.150.□.0	150	202	150 200 250 300 350	91	4.50
6500.175.□.0	175	227	150 200 250 300 350	91	4.65
6500.200.□.0	200	252	150 200 250 300 350	91	4.80
6500.250.□.0	250	302	150 200 250 300 350	91	4.95
6500.300.□.0	300	352	150 200 250 300 350	91	5.10
6500.350.□.0	350	402	150 200 250 300 350	91	5.30
6500.400.□.0	400	452	150 200 250 300 350	91	5.50

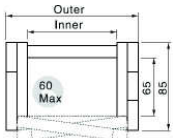

K6550 series can be open by both side

Type	Inner width (mm)	Outer width (mm)	Bending radius(mm)	Pitch (mm)	Weight (kg)
6550.100.□.0	100	152	150 200 250 300 350	91	5.50
6550.125.□.0	125	177	150 200 250 300 350	91	5.60
6550.150.□.0	150	202	150 200 250 300 350	91	5.70

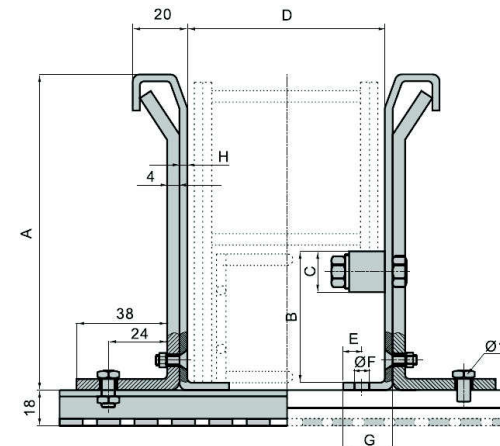
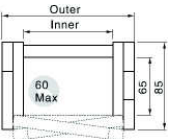

Cable tray without slide strip	1
Cable tray with slide strip	2
A	170
B	84
C	30
D	*
E	20
F	11
G	50
H	2